

REVIEW: Finding Area

Name _____

Key Concept and Vocabulary

Rectangle: $A = \ell w$

Parallelogram: $A = bh$

Triangle: $A = \frac{1}{2}bh$

Trapezoid: $A = \frac{1}{2}(b_1 + b_2)h$



Visual Model

Area of a Rectangle:

$$\begin{aligned} A &= \ell w \\ &= 12(10) \\ &= 120 \text{ square units} \end{aligned}$$

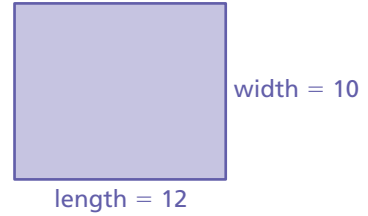

Skill Examples

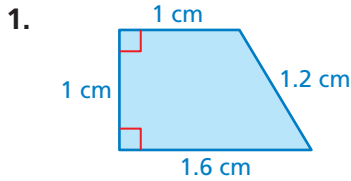

$$\begin{aligned} A &= \frac{1}{2}(1.6 + 1)(1) \\ &= 1.3 \text{ cm}^2 \end{aligned}$$

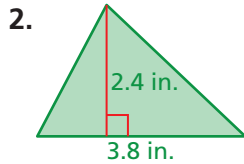

$$\begin{aligned} A &= \frac{1}{2}(3.8)(2.4) \\ &= 4.56 \text{ in.}^2 \end{aligned}$$



Application Example

3. Find the area of the rectangular apartment floor.

$$\begin{aligned} A &= 60 \cdot 40 \\ &= 2400 \end{aligned}$$

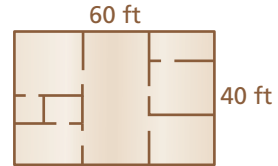

••• The area of the floor is 2400 square feet.

PRACTICE MAKES PURR-FECT®

Check your answers at BigIdeasMath.com.

Find the area of the figure.



Area = _____

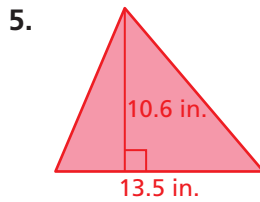

Area = _____

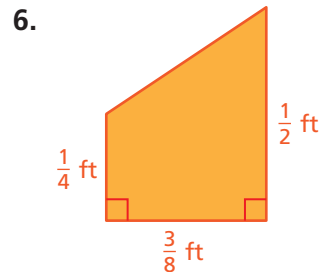

Area = _____

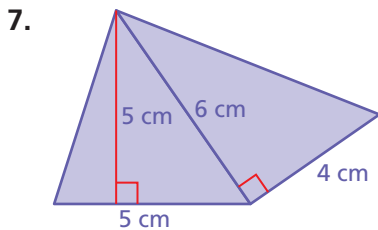

Area = _____

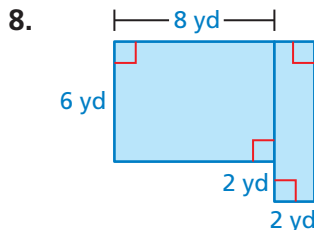

Area = _____

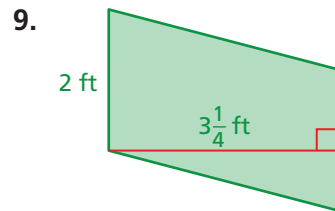

Area = _____

10. **CARPET** You are carpeting a rectangular room that is 3.5 yards wide and 4.5 yards long. The carpet costs \$15 per square yard. How much will it cost to carpet the room? _____

11. **COLORADO** Colorado is approximately a rectangle that is 280 miles wide and 380 miles long. Is the area of Colorado greater than or less than 100,000 square miles? Explain.
